



Visit us

For our clientele three generous technical centres (two at the site in Bochum and a technical center in Shanghai) are available worldwide. Different laboratory and production extruders reflect our performance.

If you want to know how we will solve your individual tasks - just call.

Under the ENTEX hotline + 49(0)234/89122-0 you can call us. Our competent team will support you quick and friendly.

We are looking forward to your visit.

ENTEX®



Headquarters

ENTEX Rust & Mitschke GmbH, Heinrichstraße 67a, 44805 Bochum, Germany
Telephone +49(0) 234/89122-0, Fax +49(0) 234/89122-99
info@entex.de, www.entex.de



Subsidiary

ENTEX International Trading Co., Ltd., No. 88, Fuyuan Road
Yaozhuang Town, Jiashan County, Jiaxing City, Zhejiang province 314117, China
Telephone +86-573-89104626 / 89104627 / 89104630, Fax +86-573-89104620
entexsh@entex.com.cn, www.entex.com.cn

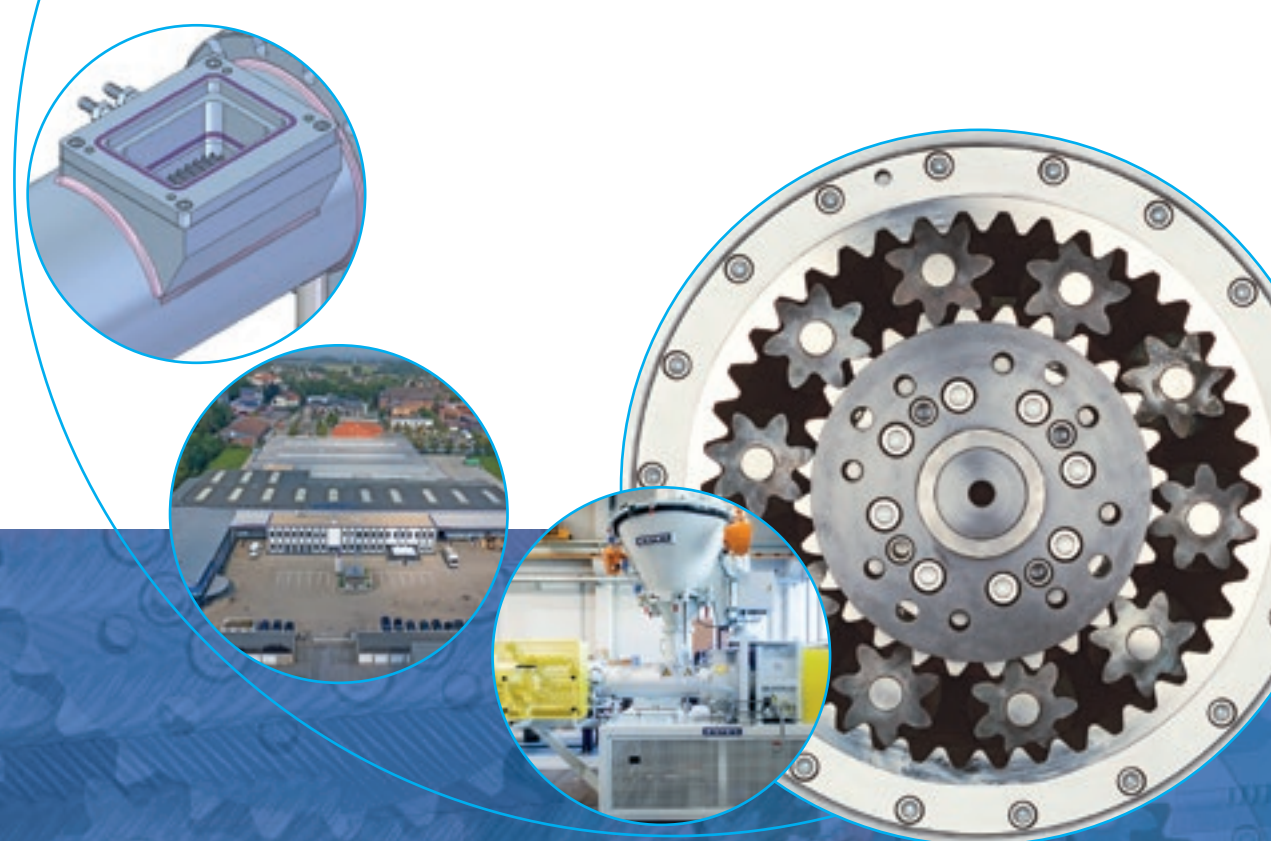

The Planetary Roller Extruder

Innovative solutions for the extrusion technology

ENTEX®



Our production lines

The Planetary Roller Extruder

The Planetary Roller Extruder is characterized by a very gentle plastification, good homogenization and dispersion as well as a low specific energy demand. The planetary roller system exists more than 60 years and since more than 30 years ENTEX places its new developments with over 150 intellectual property rights and intellectual property rights registration consequently on the world market. In this connection the line of processing ranges from the classical PVC-process to food application, at which the caoutchouc, colour, chemical, WPC industries and sludge processing may not left unmentioned.

The unique and trend-setting modular system of ENTEX offers unprecedented economical advantages and becomes manifest in the following points:

- modular construction, up to 12 cylinder assemblies can be connected in series
- most precise temperature control by means of the ENTEX thermodynamic system, due to state-of-the-art manufacturing technology
- high cooling capacity at high viscose products due to extremely large surface exchange
- due to the process geometry the Planetary Roller Extruder has an approx. fivefold larger surface compared with other compounding systems
- extremely high energy exchange at heating and cooling processes
- larger procedural window due to variation of the dosing by means of lateral feeding (side feeder)
- optimal degassing possibilities
- high degree of dispersion at gentle compounding and low speed
- system with the best self-cleaning effect of all compounding systems
- excellent product quality in a batch-performance range 1:10, i.e. the Planetary Roller Extruder must not be filled completely in order to achieve good results
- quick repeatability of material changes with minimal waste quantities

Planetary Roller Extruders of the size 3) 4)	Max. drive capacity in kW 1)	Remark	Output capacity in kg/h for PVC p/soft formulations as max. guide value 2)	Output capacity in kg/h for powder coating formulations as max. guide value 2)	Output capacity in kg/h for WPC/rubber polyolefins/thermoset formulations as max. guide value 2)
WE 50	7,5	laboratory unit	35 kg/h laboratory		
WE 70	40 - 60	laboratory unit	200 kg/h laboratory	150	120 thermoset
WE 100	41	production line	430	400	320 thermoset
WE 150	120 - 180	production line	1.300	850	680 thermoset
WE 150 S	180	production line	1.550	1.100	720 WPC
WE 180	180 - 220	production line	1.900	1.400	1.200 rubber
WE 180 S	220	production line	2.300	1.700	880 WPC
WE 200	280	module 3,5	3.000	2.000	1.600 thermoset
WE 250	280 - 350	production line	3.800	3.000	2.400 thermoset
WE 280 S	350	module 5,5	4.400	3.300	1.400 WPC
WE 300	450	production line	4.800	4.500	2.400 *
WE 400	650	production line	7.000	7.000	3.400 *
WE 400 S	450 - 2300	production line	12.000	8.000	6.000 rubber

Subject to technical alterations, issue August 2017

ENTEX-Standard program S = heavy-series
* Polyolefines with filler

- 1) Drive capacities will be designed as per procedural requirements
- 2) exact specifications are depending on the formulation
- 3) the sizes WE 140, 170, 190 and 350 will be adjusted individually to the requirements of the customer
- 4) the product range comprises also the sizes 500 as heavy-series line as well as the special toothings of the sizes 550 and 650

Specific drive capacity and melt temperature are independent, only the melt pressure depends on the quantity of the planetary spindles.
Module 3,5 TP-WE 140 for PVC

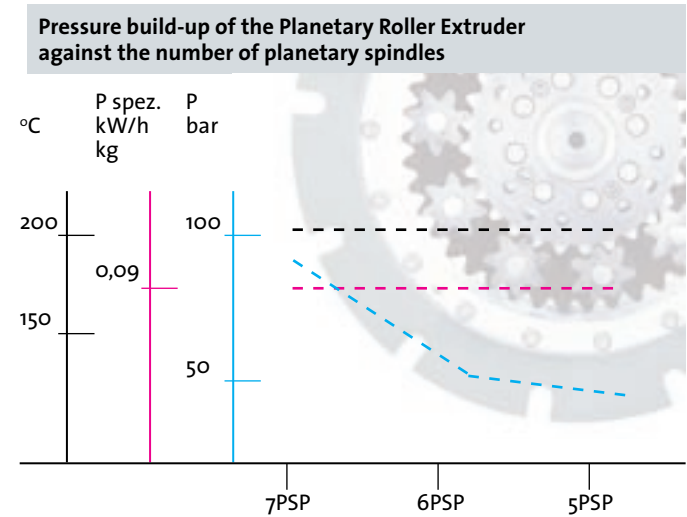

Vertical design of the building block



Module building block, developable up to 12 modules, 8 modules applications for the chemical and polymer industry

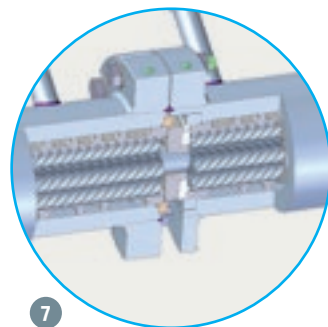
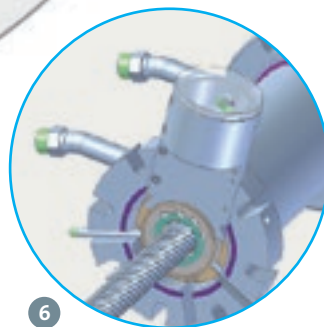
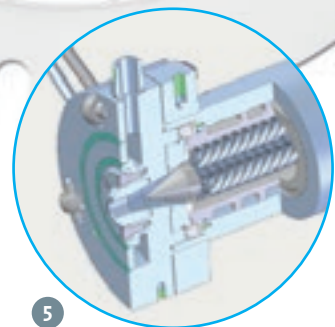
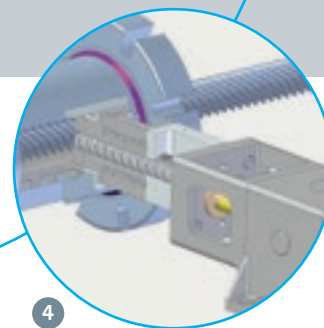
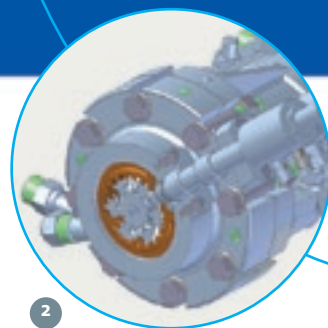
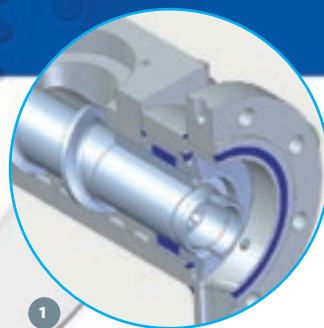

Arrangement as an example

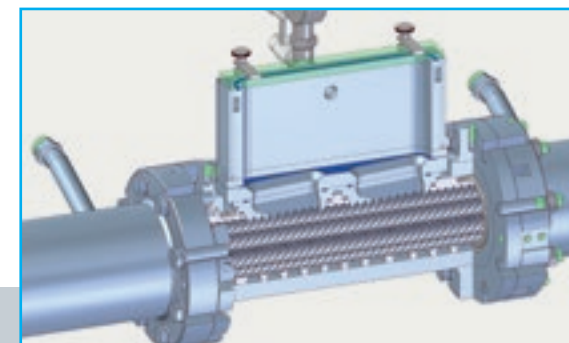
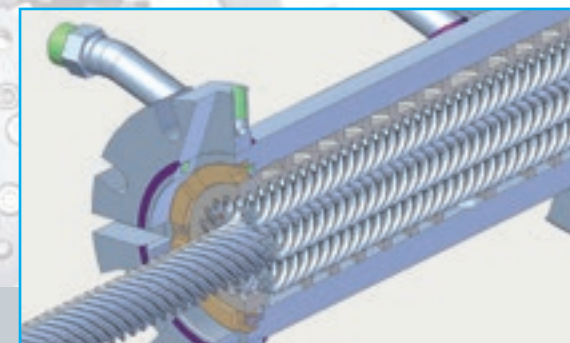
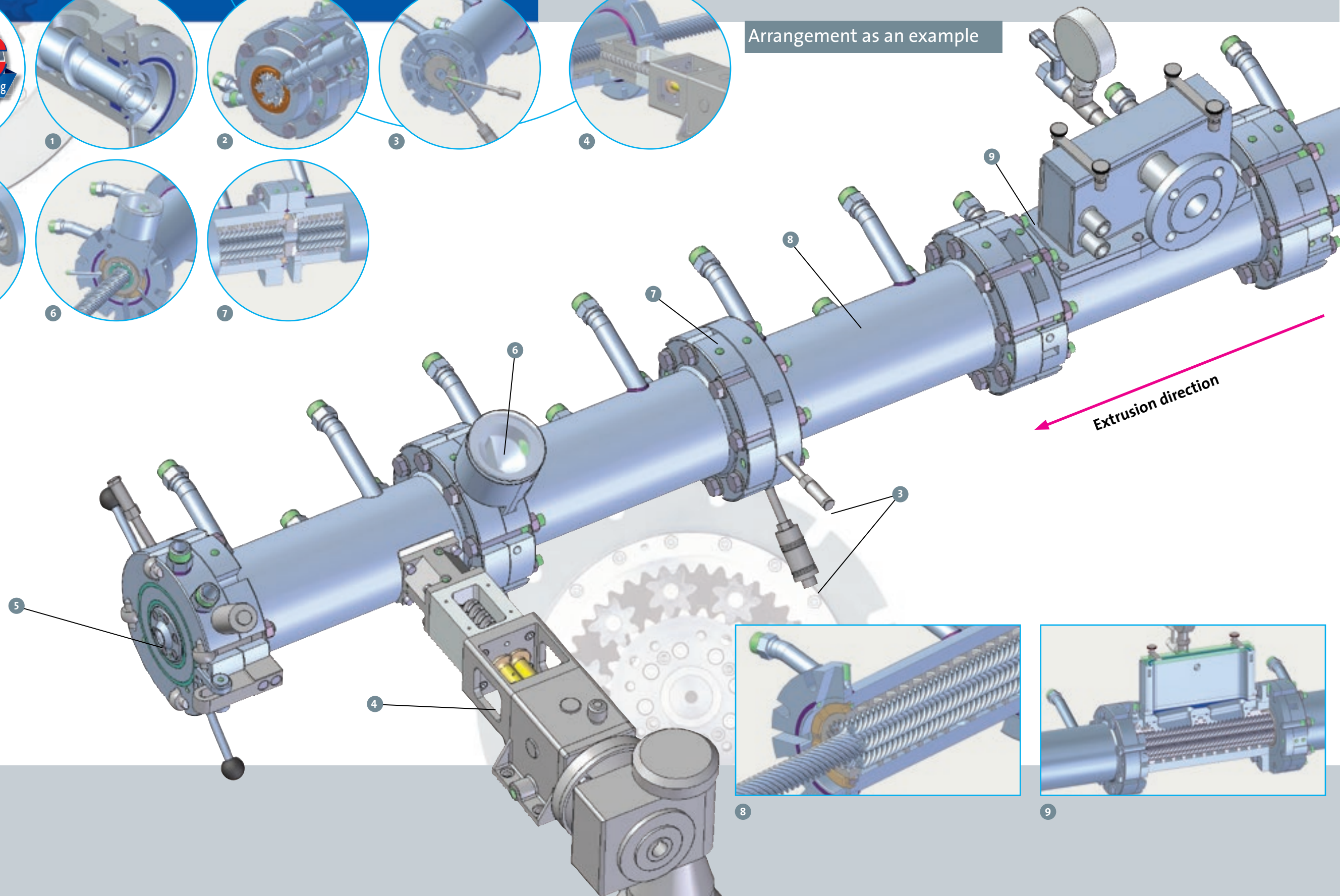

The Planetary Roller Extruder

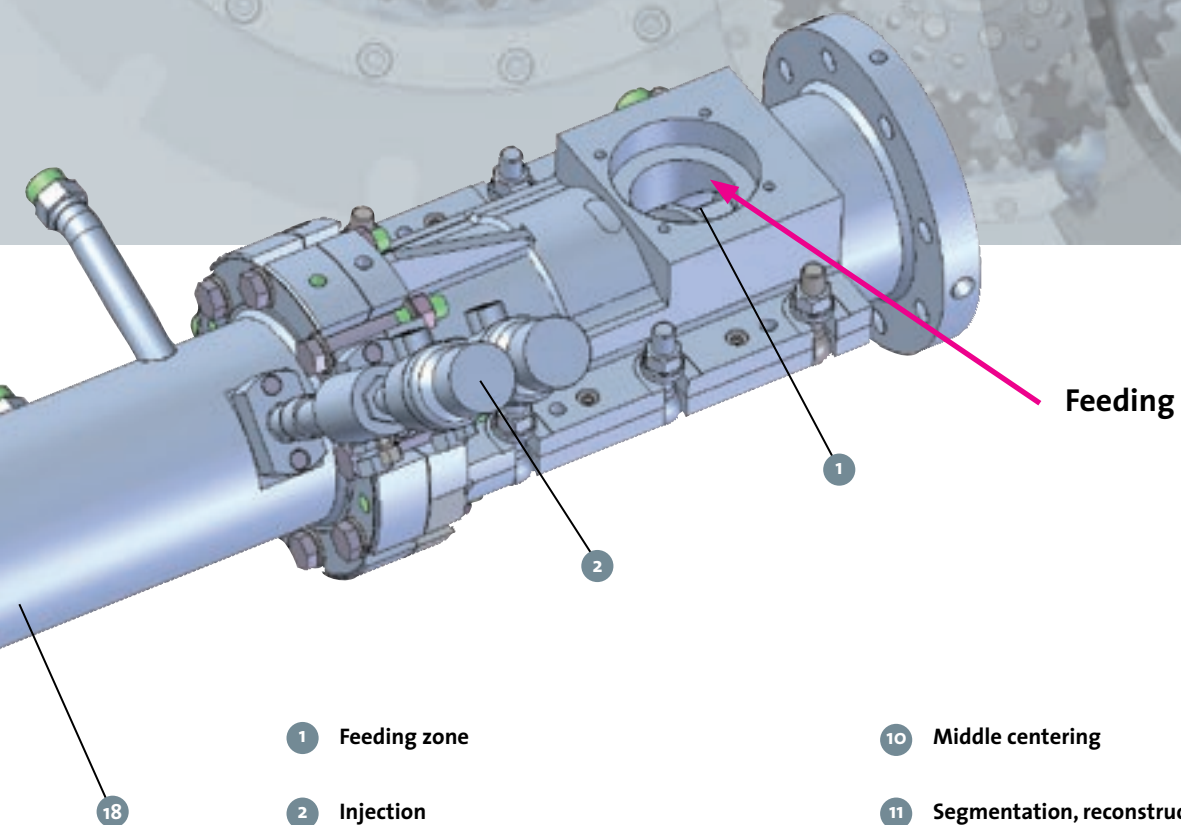

- 1 Feeding zone
- 2 Injection
- 3 Pressure/temperature measuring
- 4 Lateral feeding
- 5 Round die
- 6 Degassing between the cylinder assemblies
- 7 Dispersion ring
- 8 Cylinder assembly
- 9 Degassing cylinder
- 10 Middle centering
- 11 Segmentation, reconstruction of existing plants
- 12 Segmentation new plants
- 13 Planetary feeding cylinder (PEZ), eccentrically
- 14 Central spindle, plug-in system
- 15 Shaft, plug-in system
- 16 Feeding screw, plug-in system
- 17 Functionality planetary feeding cylinder (PEZ)
- 18 Planetary Roller Extruder actually 12 modules available (70° series)

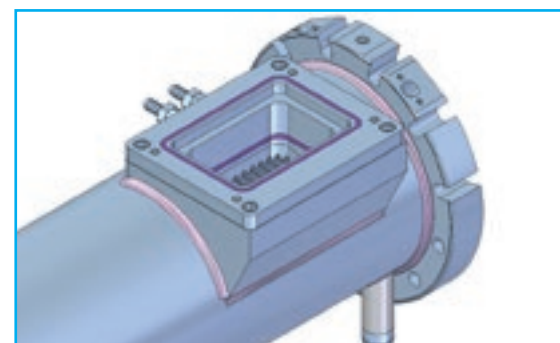

13



14



15



16

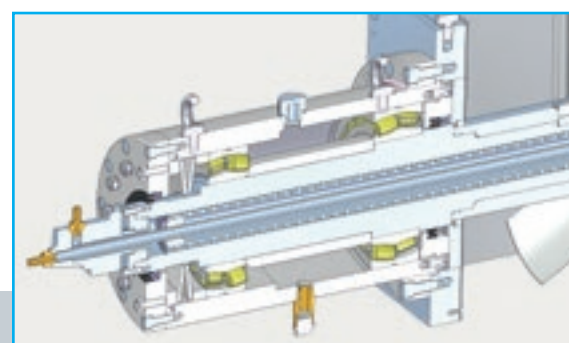

10



11

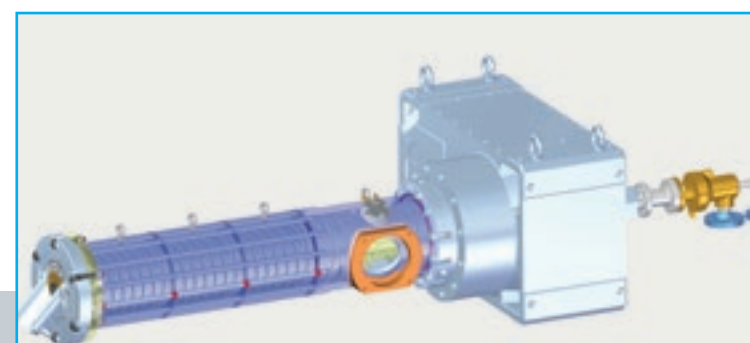

12

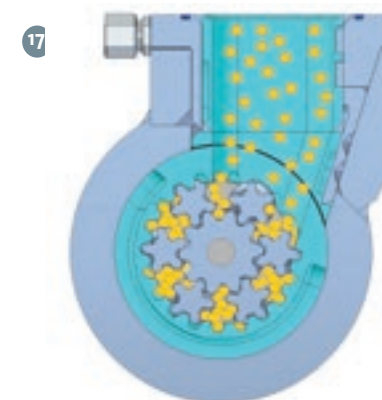

17