

Showlite Ltd
 Suite 2, Fosse House
 East Anton Court
 Andover
 Hampshire
 SP10 5RG



Contact: Ross Isolda
 T: 01264 365550
 F: 01264 365626
 E: risolda@showlite.co.uk
 W: www.showlite.co.uk

Stand Electrics Form



MED-TECH INNOVATION | EXPO
 28-29 SEPTEMBER 2021
 NEC, BIRMINGHAM, UK

Customer Purchase Order Number: _____ Stand Type: Shell Scheme Space Only

Stand Number: _____ Stand name: _____

Company Name: _____

Invoice Address: _____

Post Code: _____ Tel No: _____

Email Address for invoice to be sent to: _____

Date: _____

Please supply and install the following items on hire:

A 20% surcharge will apply to the below Costs if form is not received by the following date:			31/08/2021
Description	Cost	Quantity	Total Cost
Non 24 hour Power			
Single Socket Outlet 2amp (500w) used for.....	£114.00		
Single Socket Outlet 5amp (1000w) used for.....	£170.20		
Single Socket Outlet 10amp (2000w) used for..... Not suitable for 4way extension leads	£316.10		
Single Socket Outlet 13amp (3000w) used for..... Not suitable for 4way extension leads	£410.60		
Lighting			
Fluorescent Fitting - 5ft (1.5m)	£51.00		
Spotlight	£61.55		
Spotlight on Arm	£63.65		
Metal Halide 150w	£72.15		
Track Lighting			
1.2 Metre Track section including 3 x Spotlights	£123.60		
Test and Inspection per Stand (BS7671) MANDATORY			
Shell Scheme Stand	£15.00		
Space Only Stand who order between 1 – 5 Socket Outlets	£15.00		
Space Only Stand who order between 6 – 10 Socket Outlets	£50.00		
Space Only Stand who order 11 or more Socket Outlets	£100.00		
Bonding Fee (Please select if applicable) – A suitable Bonding point must be provided			
Shell Stands – Only applies to Metal Structures erected within shell scheme	£35.00		
Space only Stands – Applies to Stands of metal construction	£35.00		
		Sub Total	
VAT Number:		Vat 20%	
		Total	

All above price are **NON 24 hour prices** – If you require 24 hour power please contact us for a quotation.

Direct mains are available by quotation.

All direct mains ordered will need to provide relevant information at the time of quotation, full details can be given upon request.
 If a direct main Test and Inspect is required then this will be by quotation also.

For further electrical information please contact Ross Isolda by email risolda@showlite.co.uk or phone +44 (0)1264 365550

Goods/Services will not be provided unless fully paid for in advance. If you wish to pay by Credit/Debit Card please tick here
 Card payments can be made by phone, please call +44 (0)1264 365550

Cheques made payable to **Showlite Ltd**. BACS details will be available on your invoice, alternatively please contact us for details. By completing this order form you are agreeing to our Terms and Conditions. For a copy please contact us on 01264 365550.



ADDITIONAL ELECTRICS INSTRUCTIONS

NOTES: IMPORTANT PLEASE READ

Taken from E-Guide Regulations Page 55

- Multi-way plug in type and bayonet adapters shall not be used
- The use of trailing/Block type 4 way fused sockets shall be restricted to the following: one 4 way lead per fixed socket outlet, subject to a maximum loading of 500 watts total and its plug shall be fused accordingly
- A maximum flexible cord length of 2 metres from plug to trailing block unit

Taken from E-Guide Regulations Page 50

- It is the owner or user's responsibility to ensure that portable appliances are safe to be plugged into the electrical system.

Examples of Power Requirements

- | | |
|----------------------|---|
| 2amp (500w) Socket | - Laptops, Computers, TV's, DVD's, Lighting up to 500w |
| 5amp (1000w) Socket | - Small Domestic Microwaves, Lighting up to 1000w |
| 10amp (2000w) Socket | - Small Nespresso Machines, Small Vacuum Cleaner, Hair Dryers. Lighting not permitted |
| 13amp (3000w) Socket | - Vacuum Cleaner, Coffee machines, Jug Kettles, Urns. Lighting not permitted |

Note: Lighting circuits may not exceed 1000w

Please indicate the position of the electrical installations you have ordered

Back of stand

Front of stand

Raised Platform: No / Yes Heightmm

Example of 5m x 5m Stand below

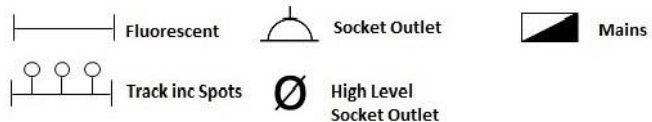
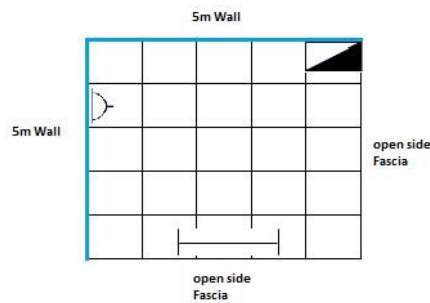

Stand Number:

Company Name:

Unless supplied with drawing the installation will be fitted at the electrician's discretion. Any complaints or faults regarding the electrical installations must be reported in writing before the close of the exhibition.